

Market Deeping Town Council

New play equipment being installed and
fencing being extended from 14th
September 2023

Market Deeping Town Council



New Fence to be placed.

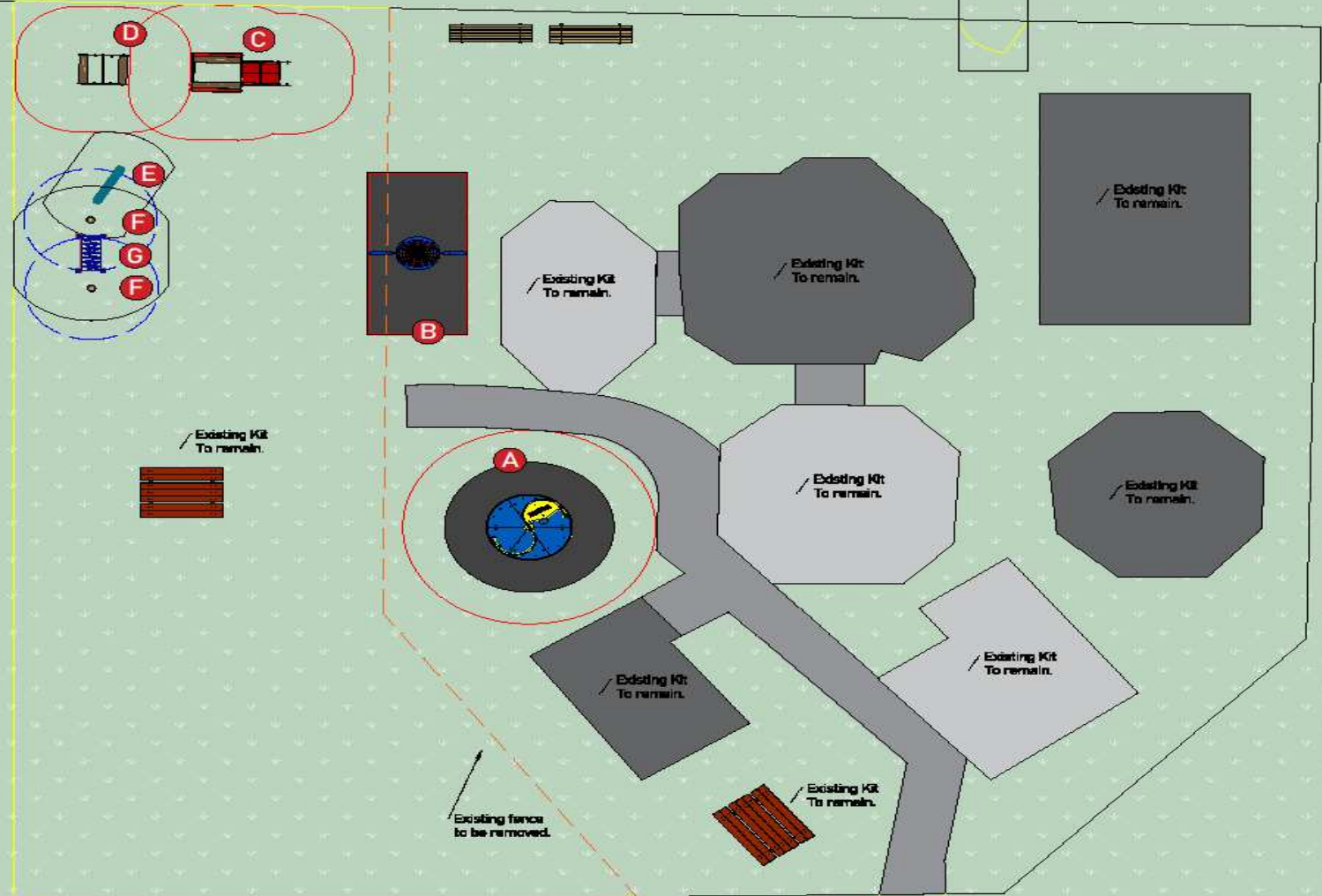

Key

- A. Swirl Roundabout
2060x975mm
- B. Mini Basket Swing-
2265x1460x1030mm
- C. Carnage-
1180x590x860mm
- D. Wicksteed Flyer-
2360x1180x1230mm
- E. Fun Trail Balance Beam
ST60- 1510 x 200 x
118mm
- F. High Rubber Stepping
Post- 200 x 300mm
- G. Mini Hump Back Bridge
ST60- 1200 x 200 x
645mm

NOTE:
Kit A-B to be placed on wet pour
Kit C-G to be placed onto grass

-orange line denotes fence to be removed
-yellow line denotes fence to be placed

DPP No: 4/88972
ISSUE No: Issue 3
DATE: 25/08/2023
DRAWN BY: Designer 20
NOTE: Artists Illustration Only
General Reinstatement to Soil & Seed Unless Stated Otherwise



0 1 2 3 4 5m
Scale: 1:100 @ A2

14924.2832

Market Deeping Town Council

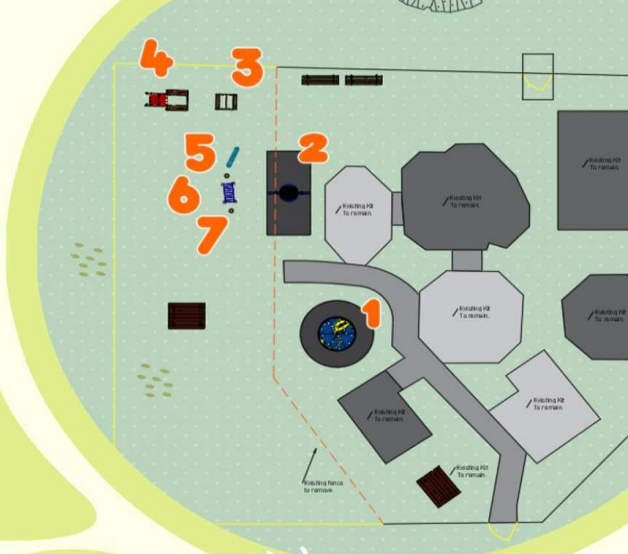

2 Mini Basket Swing



6 Mini Hump Back Bridge

1 Swirl Roundabout



5 Fun Trail Balance Beam



3 Carriage

7 Rubber Stepping Post



JOHN EVE PARK



4 Wicksteed Flyer



© 88972 - Date: 12/07/23 - Issue 2 - Drawn by: Designer:01
 Note: THIS IS AN ARTIST'S ILLUSTRATION ONLY AND IS NOT TO SCALE. PLEASE REFER TO PLAN FOR SCALED DETAIL